



Mortise Lock

ASSA ABLOY

The global leader in
door opening solutions

ASSA ABLOY Mortise Lockcase

Features & Benefits

ASSA ABLOY

Mortise Lockcase AA5200 Series

Key features:

- Made of SS 304
- 2,00,000 cycles tested
- 8 Latching functions
- Fire rated
- Non-handed - latch reversible

Benefits:

- High corrosion resistance
- High durability
- Versatile usage
- Can be used for fire doors
- Lesser number of SKU's



Standard & Certification

Fire Rated
EN1634

EN 12209

Technical details:

- Center to center - 72mm
- Backset - 60mm
- Door thickness required - 30mm to 50mm with the standard screw fixing pack provided
- Fits standard cam euro profile cylinder
- Double throw projection deadbolt - 20mm
- Suitable for hinged timber, metal and fire doors
- All mortise lockcase contain suitable strike plate and screws

The range of ASSA ABLOY mortise lockcase consists of various functions to meet the most enhanced security and locking requirements.



Mortise Lockcase - AA5200 Series

ASSA ABLOY

Mortise Lockcase AA5200 Series

8 Locking functions:

- Passage Latch
- Entrance Lockcase
- Deadlock Lockcase
- Classroom Lockcase
- Privacy Lockcase
- Nightlatch Lockcase
- Roller bolt entrance Lockcase
- Panic exit entrance Lockcase

Various locking functions for multiple applications

Dimensions:

A	B	C	D	E	F	G
60mm	88mm	72mm	30mm	165mm	38mm	30mm
H	I	J	K	L	M	N
12mm	35mm	20mm	235mm	24mm	12mm	9mm

Limiting dimensions:

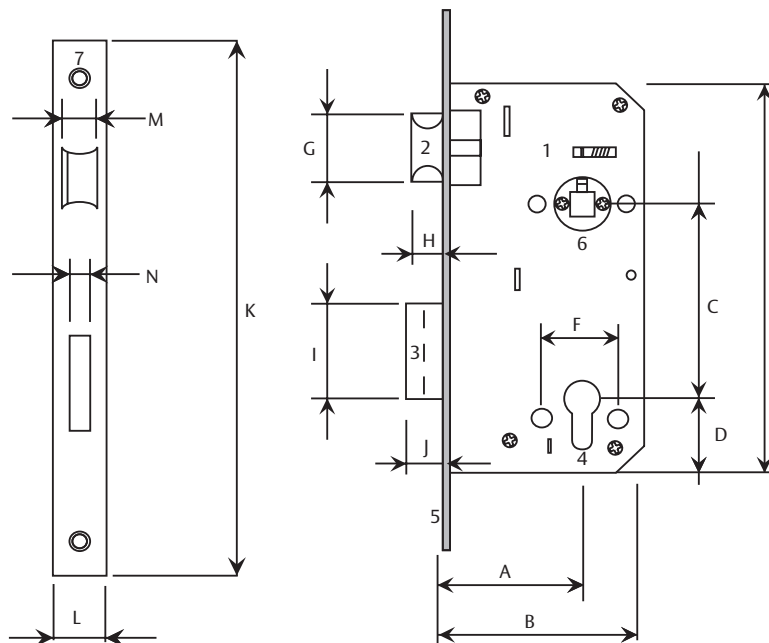

Parts:

1. Lock case
2. Latch bolt
3. Deadbolt
4. Euro cylinder hole
5. Face plate
6. Lever follower
7. Counter sunk holes

Mortise Lockcase - AA5200 Series

ASSA ABLOY

Mortise Lockcase AA5200 Series

Passage Latch

Model no.: AA5201CS

Description: AA5201 ASSA ABLOY Euro mortise lockcase
Backset: 60mm
C to C: 72mm
Door thickness: 35mm to 50mm

Finish: SSS - Satin Stainless Steel

Outside: Opened by handle at all times

Inside: Opened by handle at all times

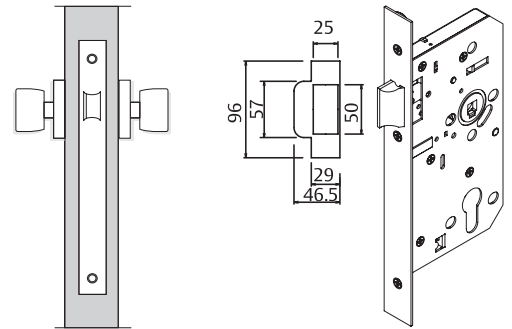

Mortise Lockcase AA5200 Series

Entrance Lockcase

Model no.: AA5203CS

Description: AA5203 ASSA ABLOY Euro mortise lockcase
Backset: 60mm
C to C: 72mm
Door thickness: 35mm to 50mm

Finish: SSS - Satin Stainless Steel

Outside: Opened by handle when unlocked.
Lever withdraws latchbolt. Key locks or unlocks
bolt key withdraws latchbolt.

Inside: Opened by handle when unlocked. Lever handle at
one side withdraws latchbolt. Key or turn locks to unlocks
the bolt, key or turn locks to withdraws latchbolt.

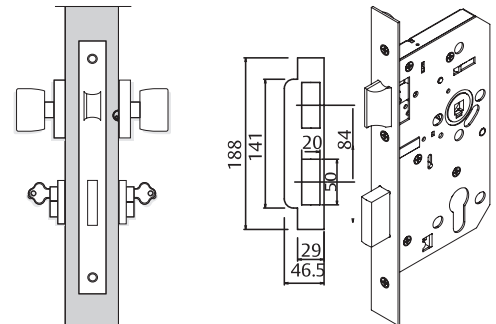

Mortise Lockcase AA5200 Series

Deadlock Lockcase

Model no.: AA5204CS

Description: AA5204 ASSA ABLOY Euro mortise lockcase
Backset: 60mm
C to C: 72mm
Door thickness: 35mm to 50mm

Finish: SSS - Satin Stainless Steel

Outside: Bolt is locked or unlocked by key or turn.

Inside: Bolt is locked or unlocked by key or turn.

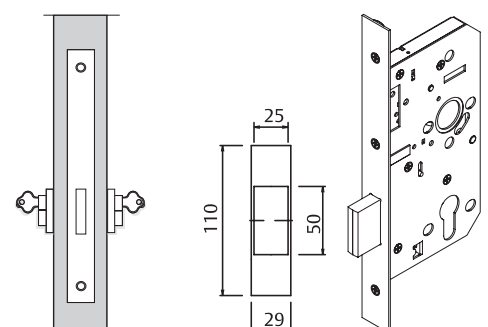

Mortise Lockcase - AA5200 Series

ASSA ABLOY

Mortise Lockcase AA5200 Series

Classroom Lockcase

Model no.: AA5205CS

Description: AA5205 ASSA ABLOY Euro mortise lockcase
Backset: 60mm
C to C: 72mm
Door thickness: 35mm to 50mm

Finish: SSS - Satin Stainless Steel

Outside: Opened by handle except when handle is made inoperative by key from outside. Key locks or unlocks outside handle.

Inside: Opened by handle at all times.

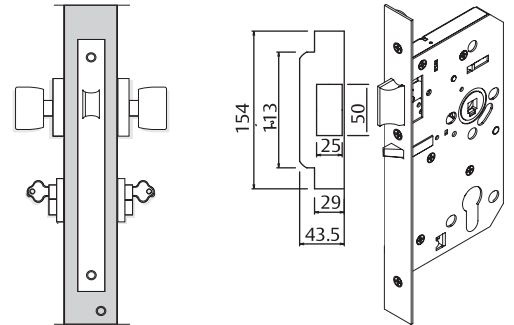

Mortise Lock AA5200 Series

Privacy Lockcase

Model no.: AA5209CS

Description: AA5209 ASSA ABLOY Euro mortise lockcase
Backset: 60mm
C to C: 72mm
Door thickness: 35mm to 50mm

Finish: SSS - Satin Stainless Steel

Outside: Opened by handle except when bolt is thrown by turn knob from inside. Bolt may be unlocked from outside by coin or screwdriver or operating the slotted emergency button.

Inside: Opened by handle except when bolt is thrown by inside turn knob.

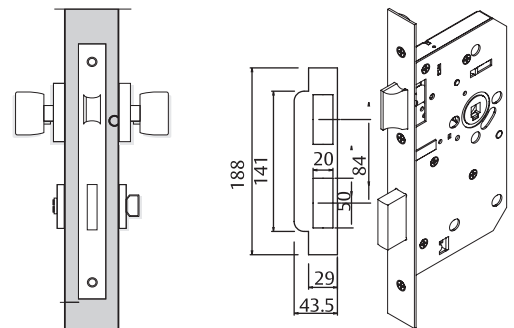

Mortise Lock AA5200 Series

Nightlatch Lockcase

Model no.: AA5206CS

Description: AA5206 ASSA ABLOY Euro mortise lockcase
Backset: 60mm
C to C: 72mm
Door thickness: 35mm to 50mm

Finish: SSS - Satin Stainless Steel

Outside: Latch is withdrawn by key or turn.

Inside: Latch is withdrawn by key in turn.

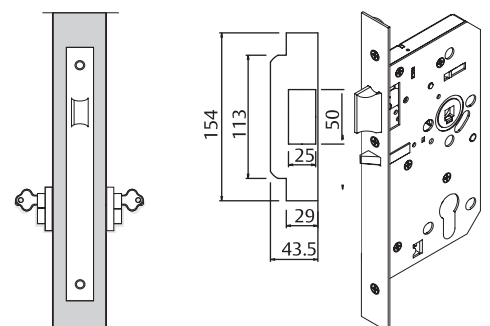

Mortise Lockcase - AA5200 Series

ASSA ABLOY

Mortise Lock AA5200 Series

Roller bolt entrance Lockcase

Model no.: AA52PRBCS

Description: AA52PRB ASSA ABLOY Euro mortise lockcase
Backset: 60mm
C to C: 72mm
Door thickness: 35mm to 50mm

Finish: SSS - Satin Stainless Steel

Outside: Bolt is locked or unlocked by key or turn.

Inside: Bolt is locked or unlocked by key or turn.

*Roller bolt can always open the door from inside and outside when door is unlocked, roller bolt is not operated by handle.

Note: Optional double door strike can be provided

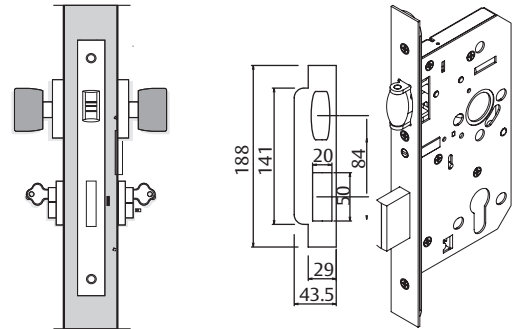

Mortise Lock AA5200 Series

Panic exit entrance Lockcase

Model no.: AA52PACS

Description: AA52PA ASSA ABLOY Euro mortise lockcase
Backset: 60mm
C to C: 72mm
Door thickness: 35mm to 50mm

Finish: SSS - Satin Stainless Steel

Outside: Outside handle is made inoperative by key or turn from inside or key from outside. Key locks or unlocks the outside handle only.

Inside: Opened by handle at all times.

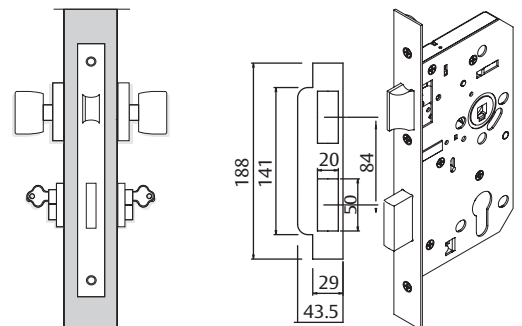

Accessories Toilet Indicator

R53-4/38

Model no.: R53-4/38

Description: ASSA ABLOY Toilet Indicator

Finish: SSS - Satin Stainless Steel

Note: To be used with Privacy mortise lockcase AA5209CS

